



Twin cylinder Diesel Engines

14-21.5 kw | 19.03-29.23 hp

# Twin Cylinder Diesel Engines

## Standard Equipment

- Electric start 12 V
- Charging alternator with voltage regulator 12 V
- Key switch
- Stop through electrovalve
- Forced air-cooling by flywheel fan
- Plastic air shroud
- Plastic oil-bath air filter
- Iron fuel tank
- In-tank pick-up mesh fuel strainer
- External spin on fuel filter
- Fuel lift pump
- Manual deaeration on injection pump
- Fuel tank drain plug
- Combined manifold and exhaust muffler with guard
- Muffler with guard
- Manual speed and stop control panel
- Forced lubrication with oil pump
- Oil sump mesh oil strainer
- Oil dipstick
- Oil drain plug
- Oil level sensor
- External spin on oil filter
- Oil cooler
- Die-cast aluminum alloy engine block
- Independent and replaceable die-cast iron cylinder liners
- Die-cast aluminum alloy cylinder heads
- Engine feet
- Top lifting eye
- Owner's manual
- Spare parts catalog

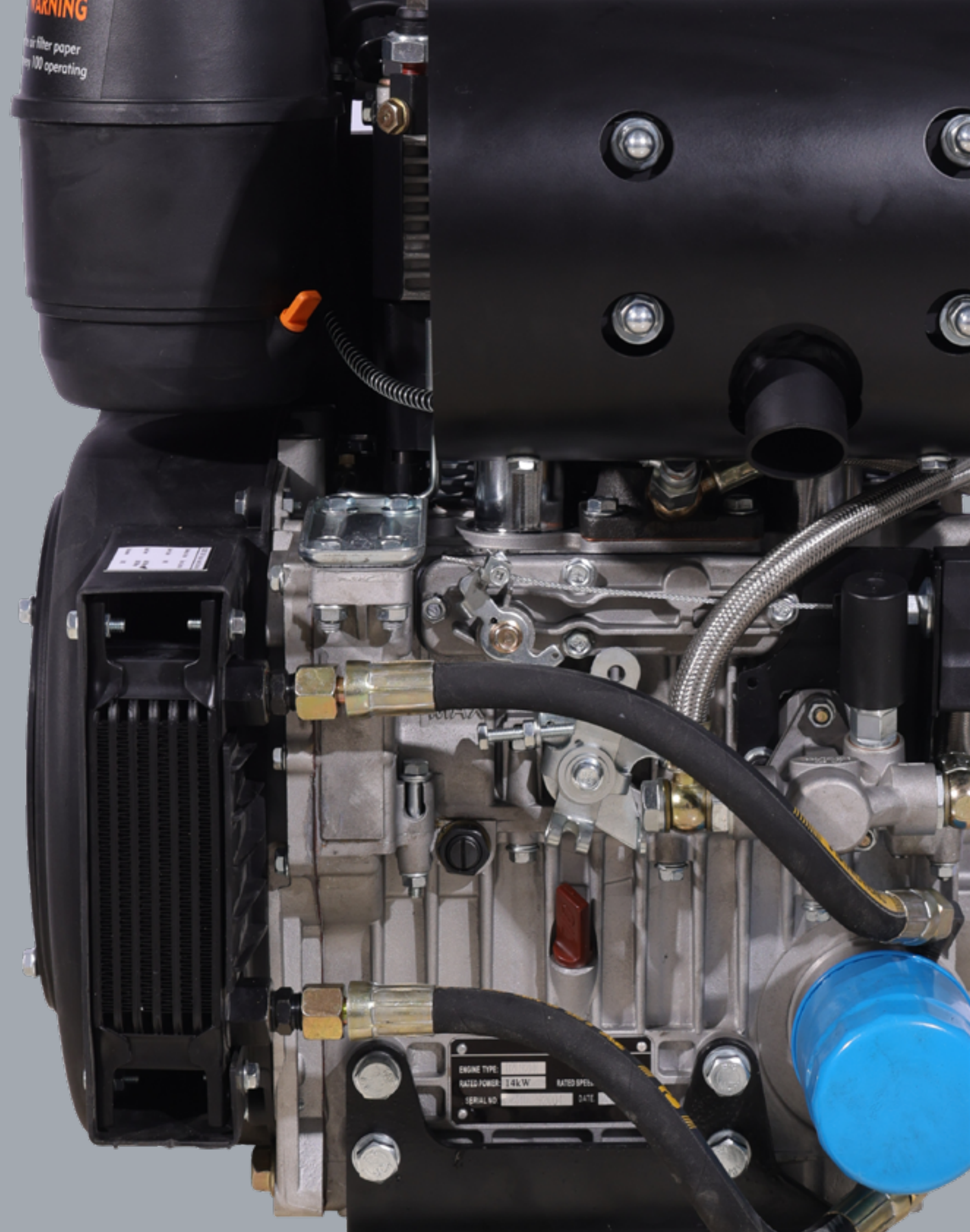

# Twin Cylinder Diesel Engines

## ACCESSORIES ON DEMAND

- Electric start 24 V
- Charging alternator with voltage regulator 24 V
- Iron oil-bath air filter
- Power take-offs with flanging and special shaft
- Power take-off on flywheel
- Glow plug on air intake manifold
- Fuel-air mixture temperature sensor
- Wiring harness
- EU STAGE V emission compliance



# D2L92F



## Data

Dimension (mm)

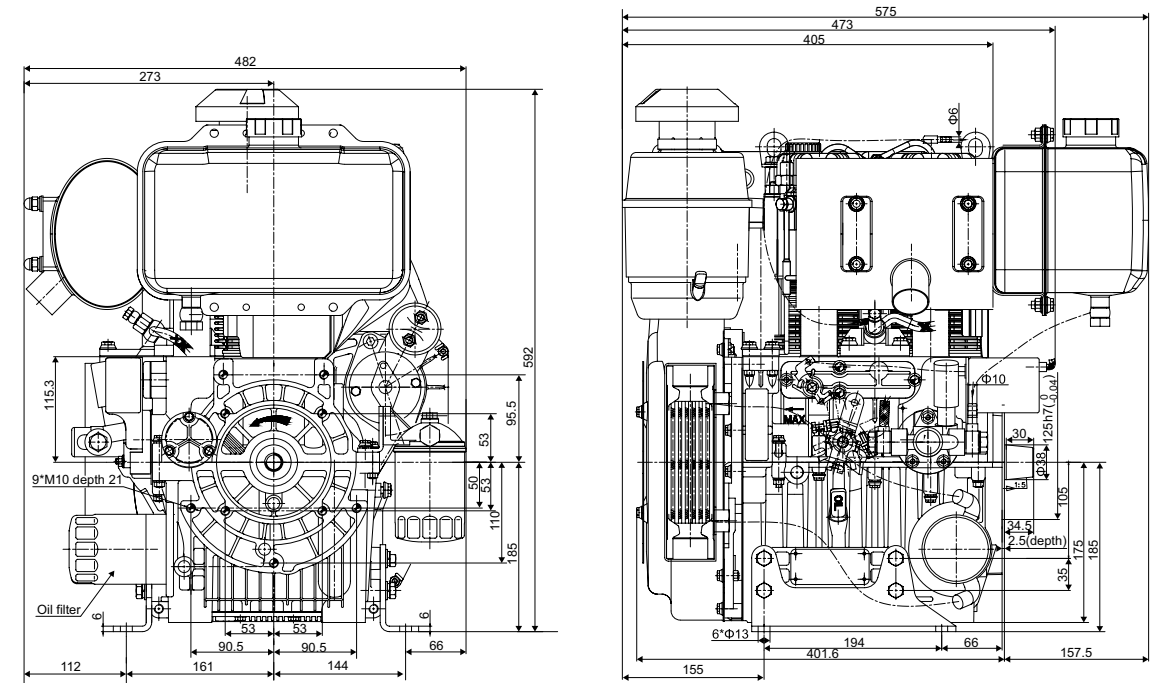

QUICK SPECIFICATIONS	D2L92FE
TYPE	Inline-twin, 4-stroke, diesel engine
Rated Output Power kw (hp) @ rpm	15.0(20.4)@3600
CYLINDERS	Twin
Engine Displacement(liter)	0.997
Cooling	Air-Cooled

## Performance curves

(ACCORDING TO ISO 14396)  
D2L92FE

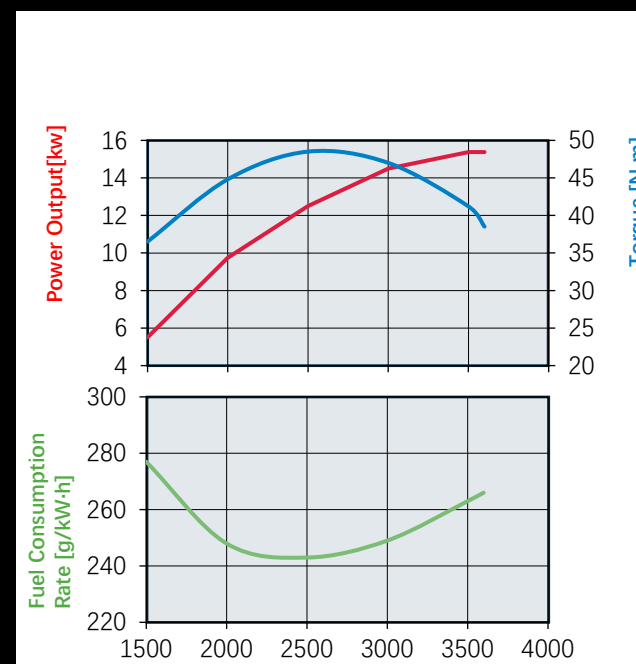

The information described in Principal Engine Specifications is for a "standard" engine. To obtain the information for the engine installed in your driven machine, please refer to the manual provided by the driven machine manufacturer.

2. Engine rating conditions are as follows (SAE J1349, ISO 3046/1):

- Atmospheric Condition: Room temperature 25°C (77°F), Atmospheric pressure 100 kPa (29.53 in Hg, 750mm Hg), Relative humidity 30%
- Fuel Temperature at Fuel Injector Pump Inlet: 40°C (104°F)
- With Cooling Fan, Air Cleaner, Muffler: CAMPES Standard
- After Engine Break-In Period. Output Allowable Deviation: ± 5%
- 1 PS = 0.7355 kW

## D2L92FE

Taper shaft  
FG

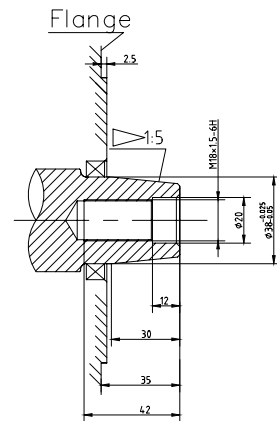

PTO flanges

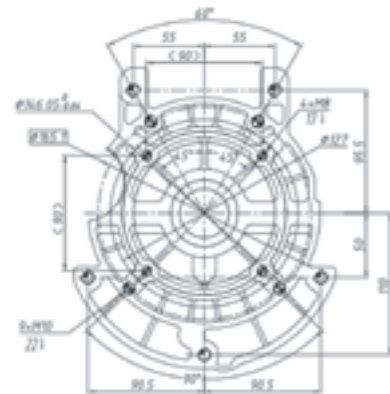
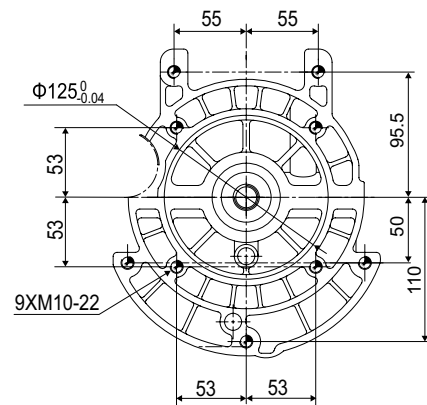

Speed Control

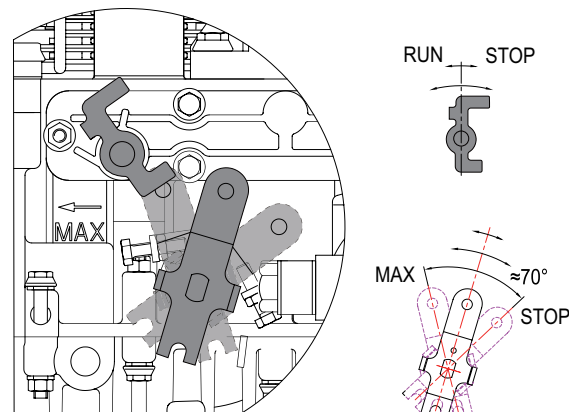

## Technical Specifications

Model		D2L92FE
Engine specs	Vertical 4-stroke air-cooled diesel engine	•
	Anticlockwise rotation viewed from PTO side	•
	Electric starting	•
	Key switch	•
	Stop through electrovalve	•
	Forced air-cooling by flywheel fan	•
	Plastic air shroud	•
	Plastic oil-bath air filter	•
	Iron fuel tank	•
	In-tank pick-up mesh fuel strainer	•
	External spin on fuel filter	•
	Fuel lift pump	•
	Manual deaeration on injection pump	•
	Fuel tank drain plug	•
	Combined manifold and exhaust muffler with guard	•
	Muffler with guard	•
	Manual speed and stop control panel	•
	Forced lubrication with oil pump	•
	Oil sump mesh oil strainer	•
	Oil dipstick	•
	Oil drain plug	•
	Oil level sensor	•
	External spin on oil filter	•
	Oil cooler	•
	Die-cast aluminum alloy engine block	•
	Independent and replaceable die-cast iron cylinder liners	•
	Die-cast aluminum alloy cylinder heads	•
Engine feet	•	
Top lifting eye	•	
Owner's manual	•	
Spare parts catalog	•	
18 months warranty	•	
Technical features	Cylinder	2, inline-twin
	Bore (mm)	92
	Stroke (mm)	75
	Engine displacement (cm <sup>3</sup> )	997
Performance	Injection system	Direct Injection
	Compression ratio	19.5:1
	Emission compliance	EU STAGE V*
	Rating (kW/PS)	(3000rpm) 14/19.03
	Max (kW/PS)	(3000rpm) 15/20.39
	Rating (kW/PS)	(3600rpm) 15/20.39
	Max (kW/PS)	(3600rpm) 16/21.75
	Max torque (Nm@rpm)	50Nm @ 2500rpm
	Min idling (rpm)	≤1800
	Service features	Fuel type
Fuel tank capacity (liter)		7.5
Fuel consumption (g/kW.h)		(3000rpm) ≤260
Fuel consumption (g/kW.h)		(3600rpm) ≤270
Lubricating oil type		SAE 10W-30, SAE 15W-40, API grade CD or higher
Lubricating oil sump capacity (liter)		2.8
Lubricating oil consumption (g/kW.h)		≤2
Lubricating oil change interval (hr)		250**
Lubricating oil filter change interval (hr)		250**
Cyclonic oil-bath air cleaner change interval (hr)		250**
Physical characteristics	Valve adjustment interval (hr)	250
	Starting motor capacity	12V 1.7kW
	Charging dynamo output after regulated by charging voltage regulator	12V DC 10A
	Net dimensions, L x W x H (mm)	575 x 482 x 592
	Dry weight w/ electric starter (kg)	83.32
Ambient operating temps (°C)	-10 to +50	

\*optional \*\*According to operating conditions

1. The information described in Principal Engine Specifications is for a "standard" engine. To obtain the information for the engine installed in your driven machine, please refer to the manual provided by the driven machine manufacturer.

2. Engine rating conditions are as follows (SAE J1349, ISO 3046/1):

• Atmospheric Condition: Room temperature 25°C (77°F), Atmospheric pressure 100 kPa (29.53 in Hg, 750mm Hg), Relative humidity 30%

• Fuel Temperature at Fuel Injector Pump Inlet: 40°C (104°F)

• With Cooling Fan, Air Cleaner, Muffler: CAMPES Standard

• After Engine Break-In Period. Output Allowable Deviation: ± 5%

• 1 PS = 0.7355 kW

# D2V88FE



## Data

Dimension (mm)

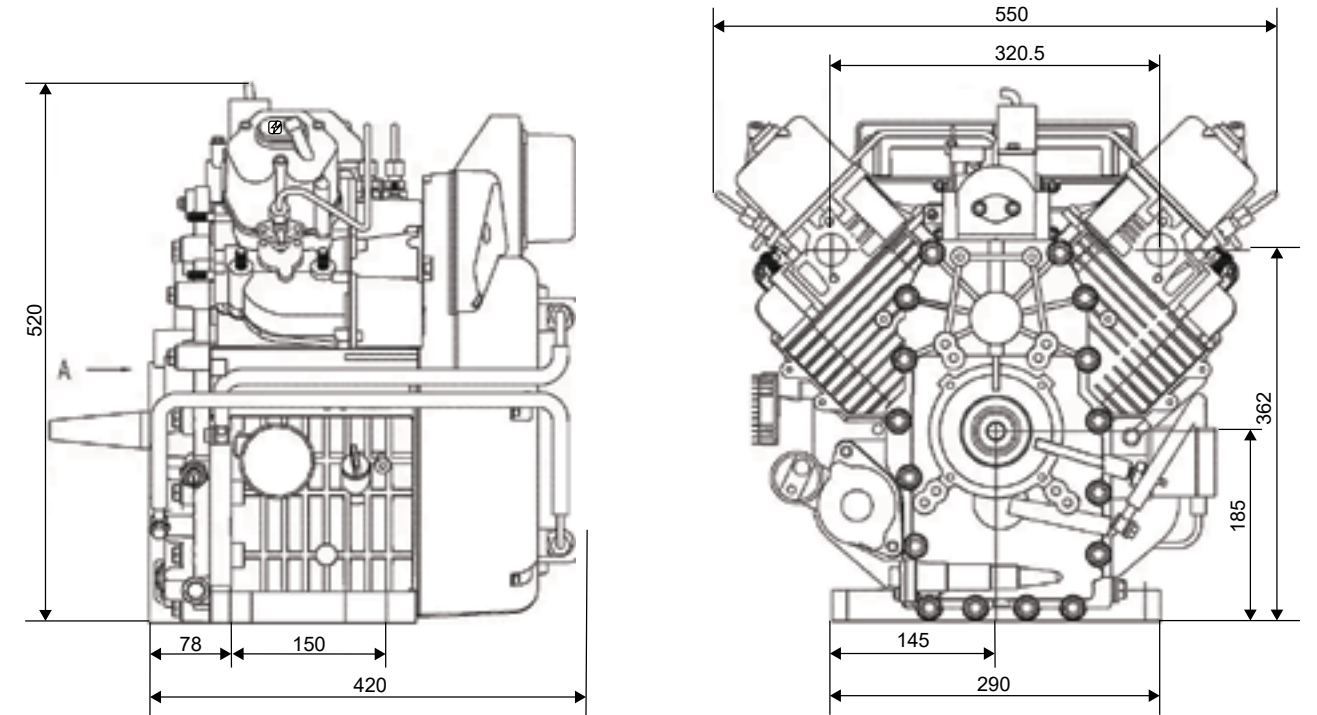

QUICK SPECIFICATIONS	D2V88FE
TYPE	V-twin, 4-stroke, diesel engine
Rated Output Power kw (hp) @ rpm	14.0(19.03)@3600
CYLINDERS	Twin
Engine Displacement(liter)	0.912
Cooling	Air-Cooled

## Performance curves

(ACCORDING TO ISO 14396)  
D2V88FE

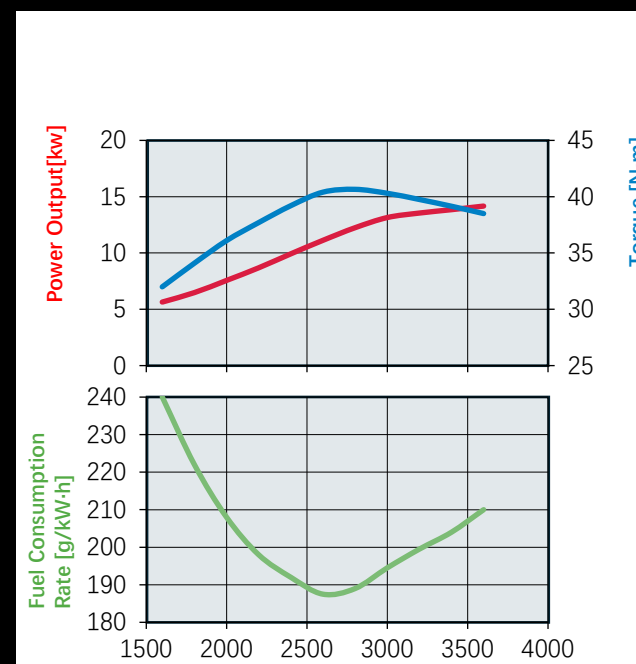

The information described in Principal Engine Specifications is for a "standard" engine. To obtain the information for the engine installed in your driven machine, please refer to the manual provided by the driven machine manufacturer.

2. Engine rating conditions are as follows (SAE J1349, ISO 3046/1):

- Atmospheric Condition: Room temperature 25°C (77°F), Atmospheric pressure 100 kPa (29.53 in Hg, 750mm Hg), Relative humidity 30%
- Fuel Temperature at Fuel Injector Pump Inlet: 40°C (104°F)
- With Cooling Fan, Air Cleaner, Muffler: CAMPES Standard
- After Engine Break-In Period. Output Allowable Deviation: ± 5%
- 1 PS = 0.7355 kW

# D2V92FE



## Data

Dimension (mm)

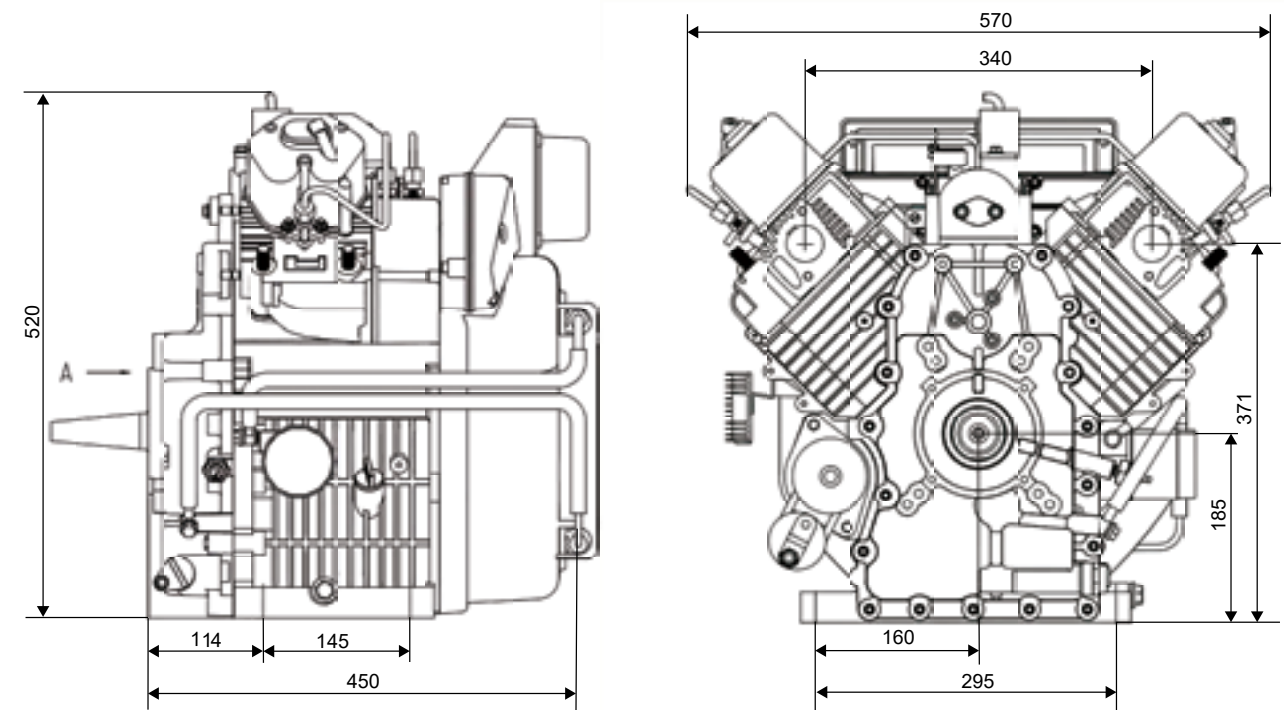

QUICK SPECIFICATIONS	D2V92FE
TYPE	V-twin, 4-stroke, diesel engine
Rated Output Power kw (hp) @ rpm	15.5(21.07)@3600
CYLINDERS	Twin
Engine Displacement(liter)	0.997
Cooling	Air-Cooled

## Performance curves

(ACCORDING TO ISO 14396)

D2V92FE

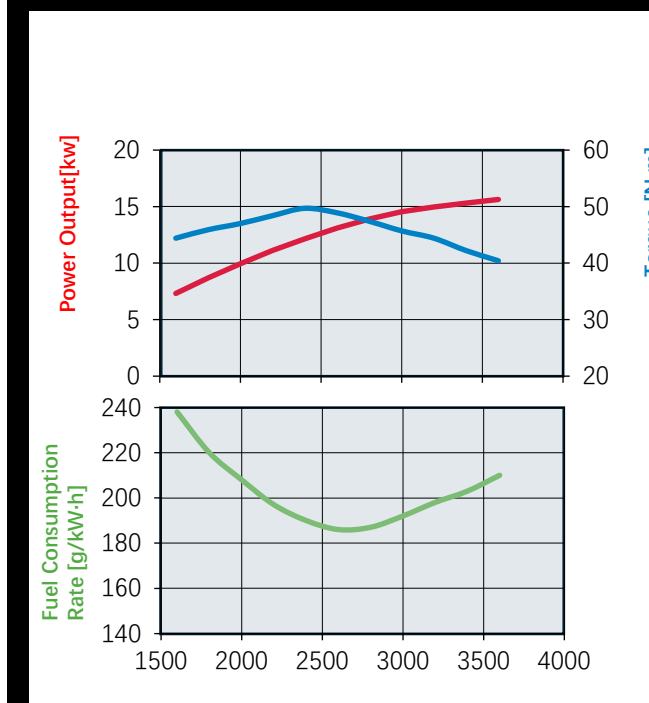

The information described in Principal Engine Specifications is for a "standard" engine. To obtain the information for the engine installed in your driven machine, please refer to the manual provided by the driven machine manufacturer.

2. Engine rating conditions are as follows (SAE J1349, ISO 3046/1):

- Atmospheric Condition: Room temperature 25°C (77°F), Atmospheric pressure 100 kPa (29.53 in Hg, 750mm Hg), Relative humidity 30%
- Fuel Temperature at Fuel Injector Pump Inlet: 40°C (104°F)
- With Cooling Fan, Air Cleaner, Muffler: CAMPES Standard
- After Engine Break-In Period. Output Allowable Deviation: ± 5%
- 1 PS = 0.7355 kW

# D2V95FE



## Data

Dimension (mm)

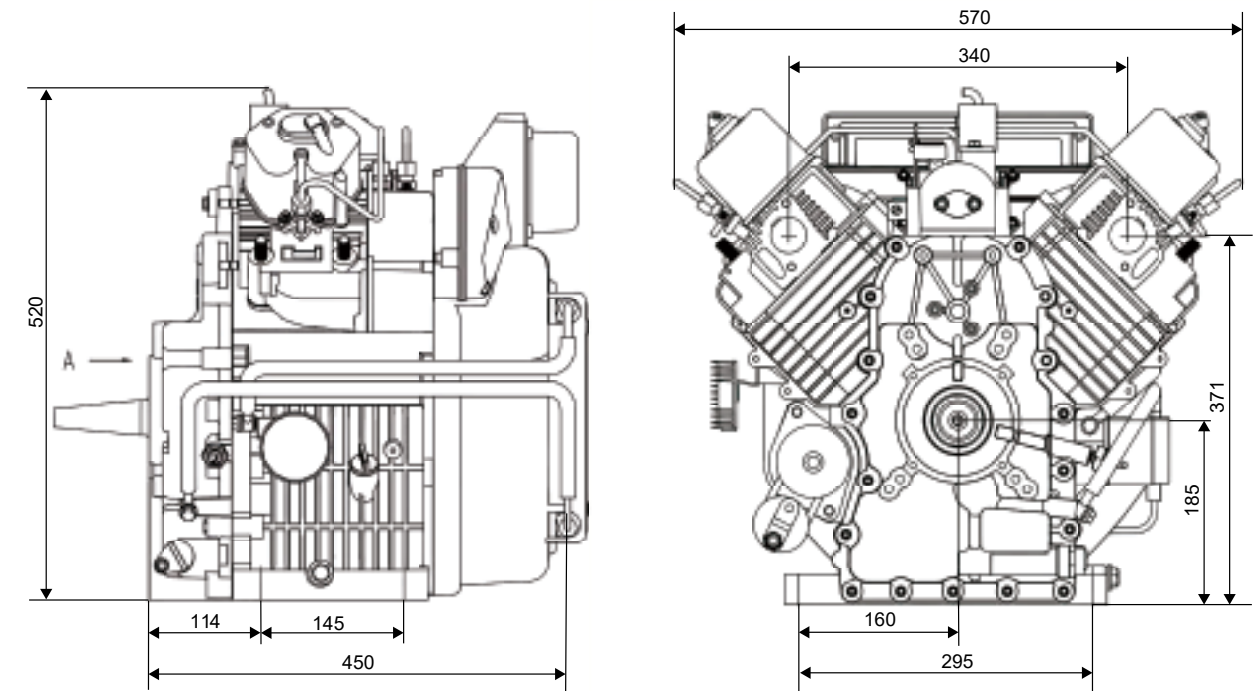

QUICK SPECIFICATIONS	D2V95FE
TYPE	V-twin, 4-stroke, diesel engine
Rated Output Power kw (hp) @ rpm	17.5(23.79)@3600
CYLINDERS	Twin
Engine Displacement(liter)	1.247
Cooling	Air-Cooled

## Performance curves

(ACCORDING TO ISO 14396)

D2V95FE

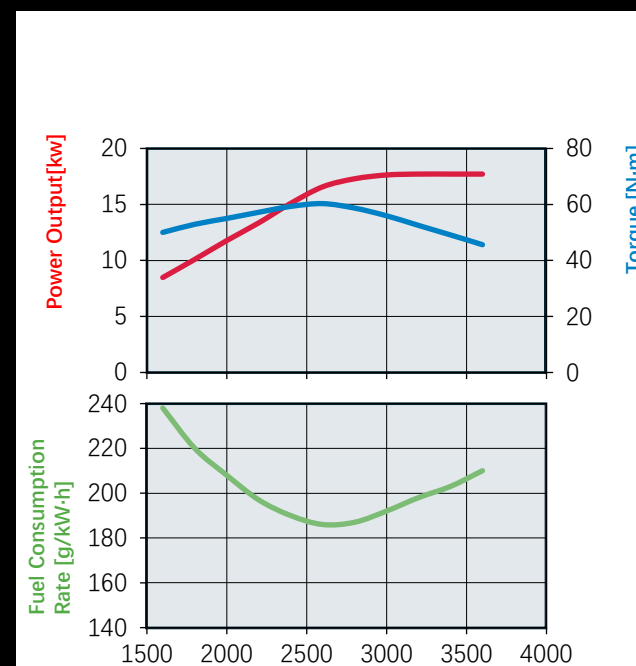

The information described in Principal Engine Specifications is for a "standard" engine. To obtain the information for the engine installed in your driven machine, please refer to the manual provided by the driven machine manufacturer.

2. Engine rating conditions are as follows (SAE J1349, ISO 3046/1):

- Atmospheric Condition: Room temperature 25°C (77°F), Atmospheric pressure 100 kPa (29.53 in Hg, 750mm Hg), Relative humidity 30%
- Fuel Temperature at Fuel Injector Pump Inlet: 40°C (104°F)
- With Cooling Fan, Air Cleaner, Muffler: CAMPES Standard
- After Engine Break-In Period. Output Allowable Deviation: ± 5%
- 1 PS = 0.7355 kW

# D2V100FE



## Data

Dimension (mm)

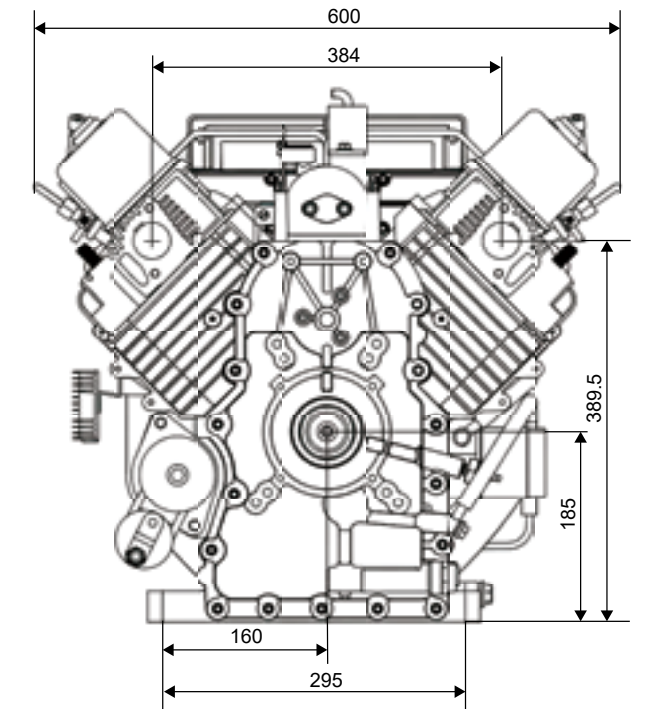
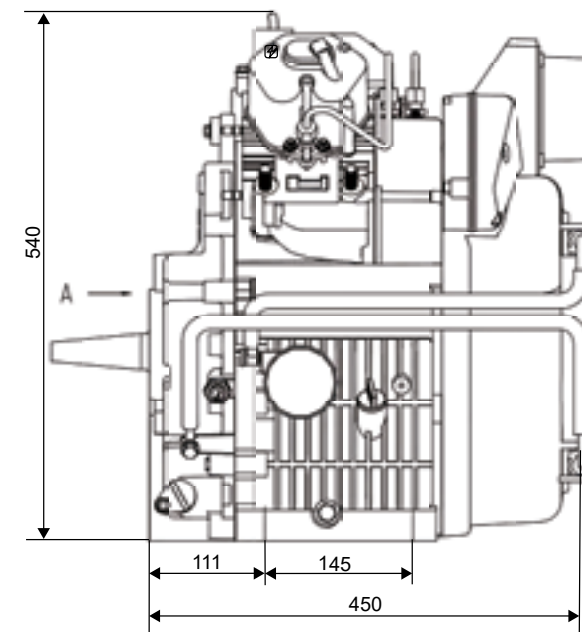

QUICK SPECIFICATIONS	D2V100FE
TYPE	V-twin, 4-stroke, diesel engine
Rated Output Power kw (hp) @ rpm	19.5(26.51)@3600
CYLINDERS	Twin
Engine Displacement(liter)	1.382
Cooling	Air-Cooled

## Performance curves

(ACCORDING TO ISO 14396)  
D2V100FE

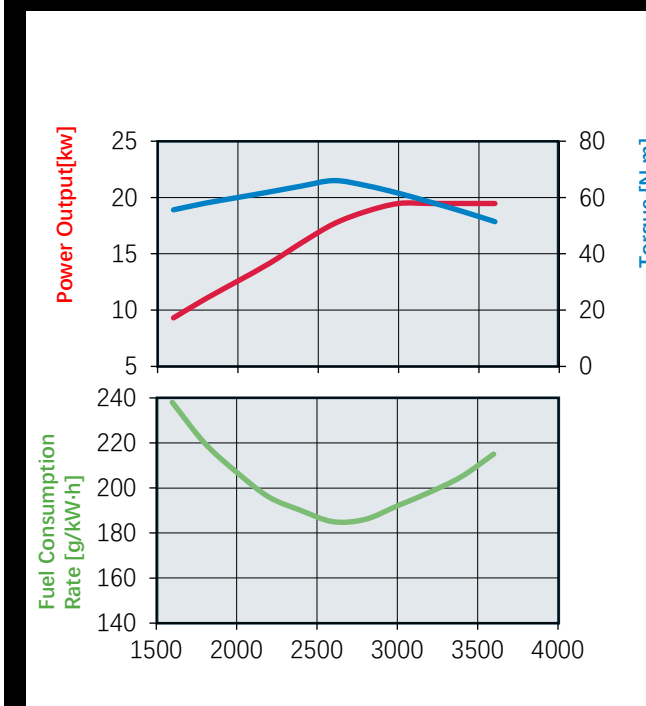

The information described in Principal Engine Specifications is for a "standard" engine. To obtain the information for the engine installed in your driven machine, please refer to the manual provided by the driven machine manufacturer.

2. Engine rating conditions are as follows (SAE J1349, ISO 3046/1):

- Atmospheric Condition: Room temperature 25°C (77°F), Atmospheric pressure 100 kPa (29.53 in Hg, 750mm Hg), Relative humidity 30%
- Fuel Temperature at Fuel Injector Pump Inlet: 40°C (104°F)
- With Cooling Fan, Air Cleaner, Muffler: CAMPES Standard
- After Engine Break-In Period. Output Allowable Deviation: ± 5%
- 1 PS = 0.7355 kW

# D2V105FE



## Data

Dimension (mm)

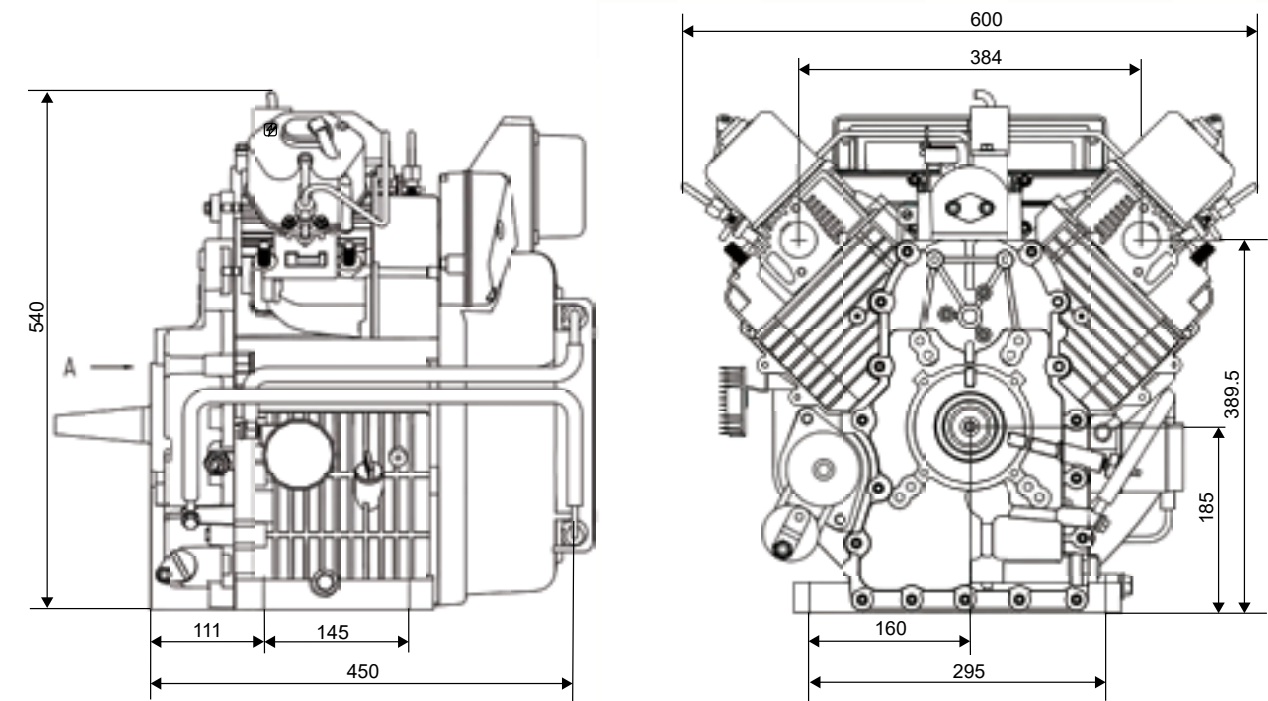

QUICK SPECIFICATIONS	D2V105FE
TYPE	V-twin, 4-stroke, diesel engine
Rated Output Power kw (hp) @ rpm	21.5(29.35)@3600
CYLINDERS	Twin
Engine Displacement(liter)	1.523
Cooling	Air-Cooled

## Performance curves

(ACCORDING TO ISO 14396)

D2V105FE

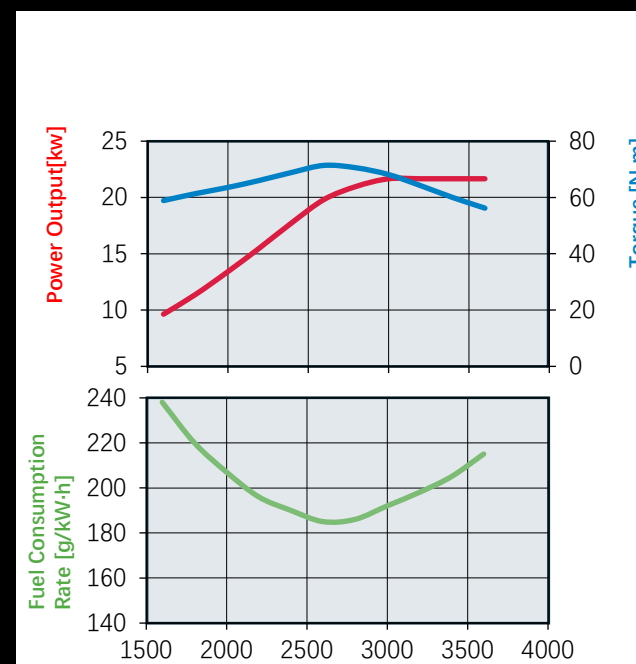

The information described in Principal Engine Specifications is for a "standard" engine. To obtain the information for the engine installed in your driven machine, please refer to the manual provided by the driven machine manufacturer.

2. Engine rating conditions are as follows (SAE J1349, ISO 3046/1):

- Atmospheric Condition: Room temperature 25°C (77°F), Atmospheric pressure 100 kPa (29.53 in Hg, 750mm Hg), Relative humidity 30%
- Fuel Temperature at Fuel Injector Pump Inlet: 40°C (104°F)
- With Cooling Fan, Air Cleaner, Muffler: CAMPES Standard
- After Engine Break-In Period. Output Allowable Deviation: ± 5%
- 1 PS = 0.7355 kW

	Keyway shaft F				Taper shaft FP		Thread shaft FS	Speed Control Flages
D2V88FE								
D2V92FE								
D2V95FE D2V100FE D2V105FE								

**Note:**

Keyway (F): Construction/Water Pumps (robust torque).

Tapered (FG): Generator Sets (precise fit).

Threaded (FP/FW): Water Pumps (easy install).

Camshaft power take-off (FS): Tillers (low-speed).

More specialized shafts are available.



Model		D2V88FE	D2V92FE	D2V95FE
Engine specs	Vertical 4 stroke air cooled diesel engine	*	*	*
	Anticlockwise rotation viewed from PTO side	*	*	*
	Electric starting	*	*	*
	Key switch	*	*	*
	Stop through electrovalve	*	*	*
	Forced air-cooling by flywheel fan	*	*	*
	Air shroud	*	*	*
	Air filter	*	*	*
	Iron fuel tank	*	*	*
	In-tank pick-up mesh fuel strainer	*	*	*
	External spin on fuel filter	*	*	*
	Fuel lift pump	*	*	*
	Fuel tank drain outlet	*	*	*
	Combined manifold and exhaust muffler with guard	*	*	*
	Manual speed and stop control panel	*	*	*
	Forced lubrication with oil pump	*	*	*
	Oil dipstick	*	*	*
	Oil drain plug	*	*	*
	Oil level sensor	*	*	*
	External spin on oil filter	*	*	*
Oil cooler	*	*	*	
Die-cast aluminum alloy engine block	*	*	*	
Die-cast iron cylinder liners	*	*	*	
Die-cast aluminum alloy cylinder heads	*	*	*	
Built-in rigid feet	*	*	*	
Owner's manual	*	*	*	
Spare parts catalog	*	*	*	
18 months warranty	*	*	*	
Performance	Cylinder	2, V-twin	2, V-twin	2, V-twin
	Bore (mm)	88	92	95
	Stroke (mm)	75	75	88
	Engine displacement (cm <sup>3</sup> )	912	997	1247
	Injection system	Direct Injection	Direct Injection	Direct Injection
	Compression ratio	(19.5±0.5):1	(19.5±0.5):1	(19.5±0.5):1
	Emission compliance	EU STAGE V*	EU STAGE V*	EU STAGE V*
	Rating (kW/PS)	(3000rpm)13/17.68	(3000rpm)14.5/19.71	(3000rpm)17.5/23.79
	Rating (kW/PS)	(3600rpm)14/19.03	(3600rpm)15.5/21.07	(3600rpm)17.5/23.79
	Max torque (Nm@rpm)	40.65Nm @ 2800rpm	49.7Nm @ 2400rpm	60.3Nm @ 2600rpm
Min idling (rpm)	≤1800	≤1800	≤1800	
Physical characteristics	Fuel type	0#(summer)-10#(winter)-35#(cold climate)		
	Fuel tank capacity (liter)	12	12	12
	Fuel consumption (g/kW.h)	(3000rpm)≤205	(3000rpm)≤205	(3000rpm)≤210
	Fuel consumption (g/kW.h)	(3600rpm)≤210	(3600rpm)≤210	(3600rpm)≤215
	Lubricating oil type	SAE 10W-30,SAE 15W-40,API grade CD or higher		
	Lubricating oil sump capacity (liter)	2.7	3.2	3.2
	Lubricating oil consumption (g/kW-h)	≤2	≤2	≤2
	Lubricating oil change interval (hr)	250**	250**	250**
	Lubricating oil filter change interval (hr)	250**	250**	250**
	Cyclonic oil-bath air cleaner change interval (hr)	250**	250**	250**
Valve adjustment interval (hr)	250	250	250	
Starting motor capacity	12V 1.7kW	12V 1.7kW	12V 1.7kW	
Charging dynamo output after regulated by charging voltage regulator	12V DC 10A	12V DC 10A	12V DC 10A	
Physical characteristics	Net dimensions, w/o fuel tank, w/o muffler, L × W × H (mm)	550 × 420 × 520	570 × 450 × 520	570 × 450 × 520
	Dry weight w/ electric starter (kg)	66	72	73
	Ambient operating temps (°C)	-10 to +50	-10 to +50	-10 to +50

\*optional \*\*According to operating conditions

1. The information described in Principal Engine Specifications is for a "standard" engine. To obtain the information for the engine installed in your driven machine, please refer to the manual provided by the driven machine manufacturer.

2. Engine rating conditions are as follows (SAE J1349, ISO 3046/1):

• Atmospheric Condition: Room temperature 25°C (77°F), Atmospheric pressure 100 kPa (29.53 in Hg, 750mm Hg), Relative humidity 30%

• Fuel Temperature at Fuel Injector Pump Inlet: 40°C (104°F)

• With Cooling Fan, Air Cleaner, Muffler: CAMPES Standard

• After Engine Break-In Period. Output Allowable Deviation: ± 5%

• 1 PS = 0.7355 kW

Model		D2V100FE	D2V105FE
Engine specs	Vertical 4 stroke air cooled diesel engine	*	*
	Anticlockwise rotation viewed from PTO side	*	*
	Electric starting	*	*
	Key switch	*	*
	Stop through electrovalve	*	*
	Forced air-cooling by flywheel fan	*	*
	Air shroud	*	*
	Air filter	*	*
	Iron fuel tank	*	*
	In-tank pick-up mesh fuel strainer	*	*
	External spin on fuel filter	*	*
	Fuel lift pump	*	*
	Fuel tank drain outlet	*	*
	Combined manifold and exhaust muffler with guard	*	*
	Manual speed and stop control panel	*	*
	Forced lubrication with oil pump	*	*
	Oil dipstick	*	*
	Oil drain plug	*	*
	Oil level sensor	*	*
	External spin on oil filter	*	*
Oil cooler	*	*	
Die-cast aluminum alloy engine block	*	*	
Die-cast iron cylinder liners	*	*	
Die-cast aluminum alloy cylinder heads	*	*	
Built-in rigid feet	*	*	
Owner's manual	*	*	
Spare parts catalog	*	*	
18 months warranty	*	*	
Performance	Cylinder	2, V-twin	2, V-twin
	Bore (mm)	100	105
	Stroke (mm)	88	88
	Engine displacement (cm <sup>3</sup> )	1382	1523
	Injection system	Direct Injection	Direct Injection
	Compression ratio	(19.5±0.5):1	(19.5±0.5):1
	Emission compliance	EU STAGE V*	EU STAGE V*
	Rating (kW/PS)	(3000rpm)19.5/26.51	(3000rpm)21.5/29.23
	Rating (kW/PS)	(3600rpm)19.5/26.51	(3600rpm)21.5/29.23
	Max torque (Nm@rpm)	66Nm @ 2600rpm	74.41Nm @ 2600rpm
Min idling (rpm)	≤1800	≤1800	
Physical characteristics	Fuel type	0#(summer)-10#(winter)-35#(cold climate)	
	Fuel tank capacity (liter)	12	12
	Fuel consumption (g/kW.h)	(3000rpm)≤215	(3000rpm)≤215
	Fuel consumption (g/kW.h)	(3600rpm)≤220	(3600rpm)≤220
	Lubricating oil type	SAE 10W-30,SAE 15W-40,API grade CD or higher	
	Lubricating oil sump capacity (liter)	3.2	3.2
	Lubricating oil consumption (g/kW-h)	≤2	≤2
	Lubricating oil change interval (hr)	250**	250**
	Lubricating oil filter change interval (hr)	250**	250**
	Cyclonic oil-bath air cleaner change interval (hr)	250**	250**
Valve adjustment interval (hr)	250	250	
Starting motor capacity	12V 1.7kW	12V 1.7kW	
Charging dynamo output after regulated by charging voltage regulator	12V DC 10A	12V DC 10A	
Physical characteristics	Net dimensions, w/o fuel tank, w/o muffler, L × W × H (mm)	600 × 450 × 540	600 × 450 × 540
	Dry weight w/ electric starter (kg)	74	75
	Ambient operating temps (°C)	-10 to +50	-10 to +50



---

## **Bruce Zhai**

+86 15896463440  
bruce@campes-group.com

## **Jane Fu**

+86 15190210056  
jane@campes-group.com

## **Address**

East Jincheng Road, Xin Wu  
District, Wuxi, Jiangsu, China